

MRD 1020

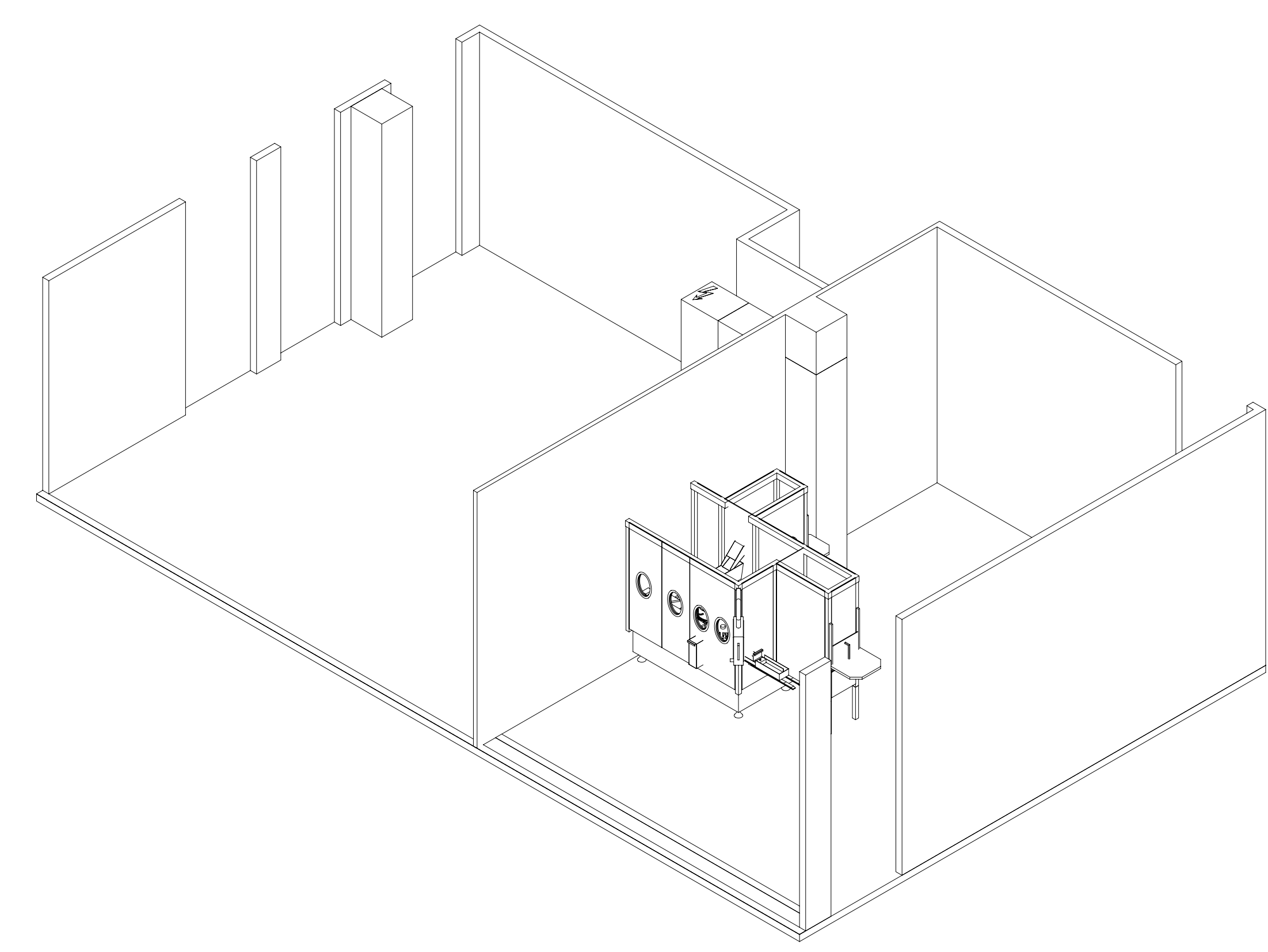
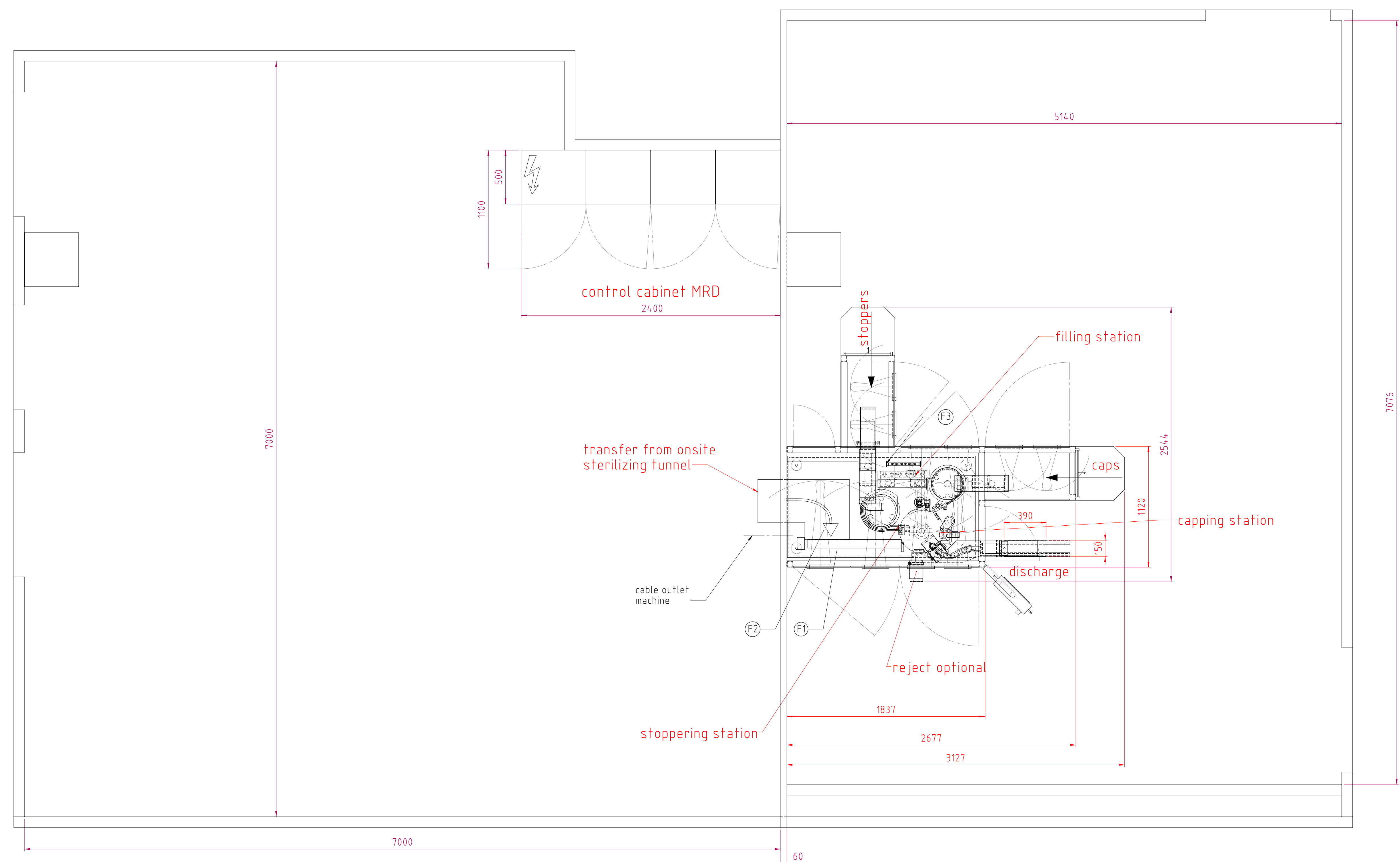

Shandong Luoxin
China

- LEGEND
 F1 Steuerluft / control air
 F2 Vakuumpumpen/ vacuum pumps
 F3 Produktzufuhr / product recipient

Version 1.0

03	27.10.2014	Z-Bock_Led	tlc	release		
02	21.07.2014	Z-Bock_Led	tlc	discharge modified, filling station modified		
01	11.11.2013	Z-Bock_Led	tlc	room added		
00	19.09.2013	Z-Bock_Led	tlc	19.09.2013 A_Zedler	Revised/Reg	see BOSCH PA guideline 9_0412
Rev. Change/And.	DDM/YYY	Drawn/Grp	BWk	DDM/YYY	Checked/Grp	BOSCH PA Richtlinie 9_0412 beachten
Customer/Kunde	Shandong Luoxin			Material	-----	
Country/Land	China			Material	-----	
Location/Ort	Origin/ Ursprung 8-113-088-771			Material class	-----	
Machine Type/Maschinenart	Sonstiges PHL			MRD1020	-----	
Lang/Spr	en/de			Shandong Luoxin, China	-----	
en/de	323720.01g			722252	-----	
Product/Produkt	MRD1020			8-100-722-252	-----	
	Scale/Maßstab 1:20			Syst	-----	
				SW	-----	
				DBW	-----	

(c) Robert Bosch GmbH. Alle Rechte vorbehalten. All rights reserved. Reproduction, distribution, or use in any form or by any means without the prior written permission of Robert Bosch GmbH is prohibited.